

POUSSOIR COURT ROUGE AVEC RONDELLE LUMINESCENTE  
 ENDURANCE MECANIQUE:100 000 CYCLES  
 ETANCHEITE FACE AVANT SUIVANT:  
 MIL STD 810 D-506.2 METHODE 2  
 AUTRES CARACTERISTIQUES,IDENTIQUE A :

SHORT RED BUTTON WITH LUMINESCENT WASHER  
 MECHANICAL STRENGTH:100 000 CYCLES  
 WATERPROOF FRONT FACE IN COMFORMITY WITH:  
 MIL STD 810 D-506.2 METHODE 2  
 OTHER CHARACTERISTICS IDENTICAL TO :

FT83453001FR

83453027

Product:

B

C.C.T.DEF.00793.FR : Modification cote suite evolution corps 79252315  
 5.8 -> 6.3

Modified by	C_BODIN	09/02/2012
Verified by	V_CAILLET	09/02/2012
Authorized by		

Toler. gene. lin $\pm$	mm
Toler. gene. Ang $\pm$	degres

This document is the property of Crouzet-Automatismes.  
 It's contents cannot be reproduced or divulged without the company's written approval.  
 The product data and specifications found on this document do not constitute any contractual obligation.  
 Crouzet-Automatismes and its subsidiaries reserve the right to modify the specifications.  
 All rights of reproduction, modification, reprinting, and translation reserved for all countries

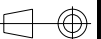

General Ra ✓  
 Raw surface

Scale  
 1/1

2, rue du Dr ABEL  
 BP 59, 26902,  
 Valence CEDEX 9  
 France

Customer: Customer Ref.:

Designation/FR: **BP BIPOLAIRE ROUGE COURT ETANCHE AVEC RONDELLE LUMINESCENTE**

PFT001:0<C>;0<M>

Designation/GB: **WATERPROOF SHORT PUSH-BUTTON CHANGE-OVER TACTILE-EFFECT TWO-POLE**

Dispatching **01**

Department: Design by F\_MONCHAL 16/10/2008

DATA SHEET

Index Format Folio

CT Verif. by A\_BONNARD 16/10/2008

**FT83453027FR**

**B A4 1/1**

NATO code: FA0X2 Authorized by