

RED BUTTON

MECHANICAL STRENGTH: 100 000 CYCLES

ELECTRICAL CHARACTERISTICS

VOLTAGE	2 - 5 VDC
CURRENT	0.15 mA - 50 mA
ELECTRICAL LIFE	100 000 cycles

OTHER CHARACTERISTICS IDENTICAL TO :

FT83450001FR

SCALE 1/1



83450029

Product:

A

Up date drawing.

Modified by	T_VINARD	12/04/2011
Verified by	P_GIROUD	12/04/2011
Authorized by	NON APPLIC.	

Toler. gene. lin ± 0.1 mm

Toler. gene. Ang ± 3 degrees



General Raw surface Ra ✓

This document is the property of Crouzet-Automatismes.
It's contents cannot be reproduced or divulged without the company's written approval.
The product data and specifications found on this document do not constitute any contractual obligation.
Crouzet-Automatismes and its subsidiaries reserve the right to modify the specifications.
All rights of reproduction, modification, reprinting, and translation reserved for all countries

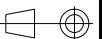

Scale
1/1

2, rue du Dr ABEL
BP 59, 26902,
Valence CEDEX 9
France

Customer:

Customer Ref.:

Designation/FR:

BOUTON POUSSOIR ETANCHE ROUGE - BAS NIVEAU

PFT001:0<C>;0<M>

Designation/GB:

PUSH-BUTTON ROUGE - LOW CURRENT

Dispatching **01**

Department:

Design by T_VINARD 12/04/2011

DATA SHEET - FICHE TECHNIQUE

Index Format Folio

CT

Verif. by P_GIROUD 12/04/2011

FT83450029GB

A A4 1/1

NATO code: FA0X2

Authorized by NON APPLIC.